

- 01 QBT 450™ ROOF TRAY
- 02 PRE-MANUFACTURED APRON FLASHING
- 03 QBT 450™ CONTINUOUS ALUMINIUM EXTRUSION
- 04 UPSTAND TO ROOFTRAY
- 05 PRE-MANUFACTURED RECEIVER FLASHING AND VENT STRIP
- 06 45 X 70 mm H3.2 TREATED TIMBER BATTEN @ 450 CENTRES
- 07 VAPOUR PERMABLE ROOF UNDERLAY
- 08 10-GAUGE STAINLESS STEEL PAN HEAD 50MM, OR 2.8 X 50 mm FLAT HEAD R-DRIVE GALV NAILS
- 09 AIR-Z 3-D WOVEN MESH
- 10 ROOF STRUCTURE
- 11 20 X 50 mm H3.2 TREATED CAVITY BATTEN
- 12 SEALED RIVET
- 13 10-GAUGE by 100mm PURLIN AND BATTEN SCREW

REFER TO SECTION 10, TABLE 10.12 NZS 3604:2011

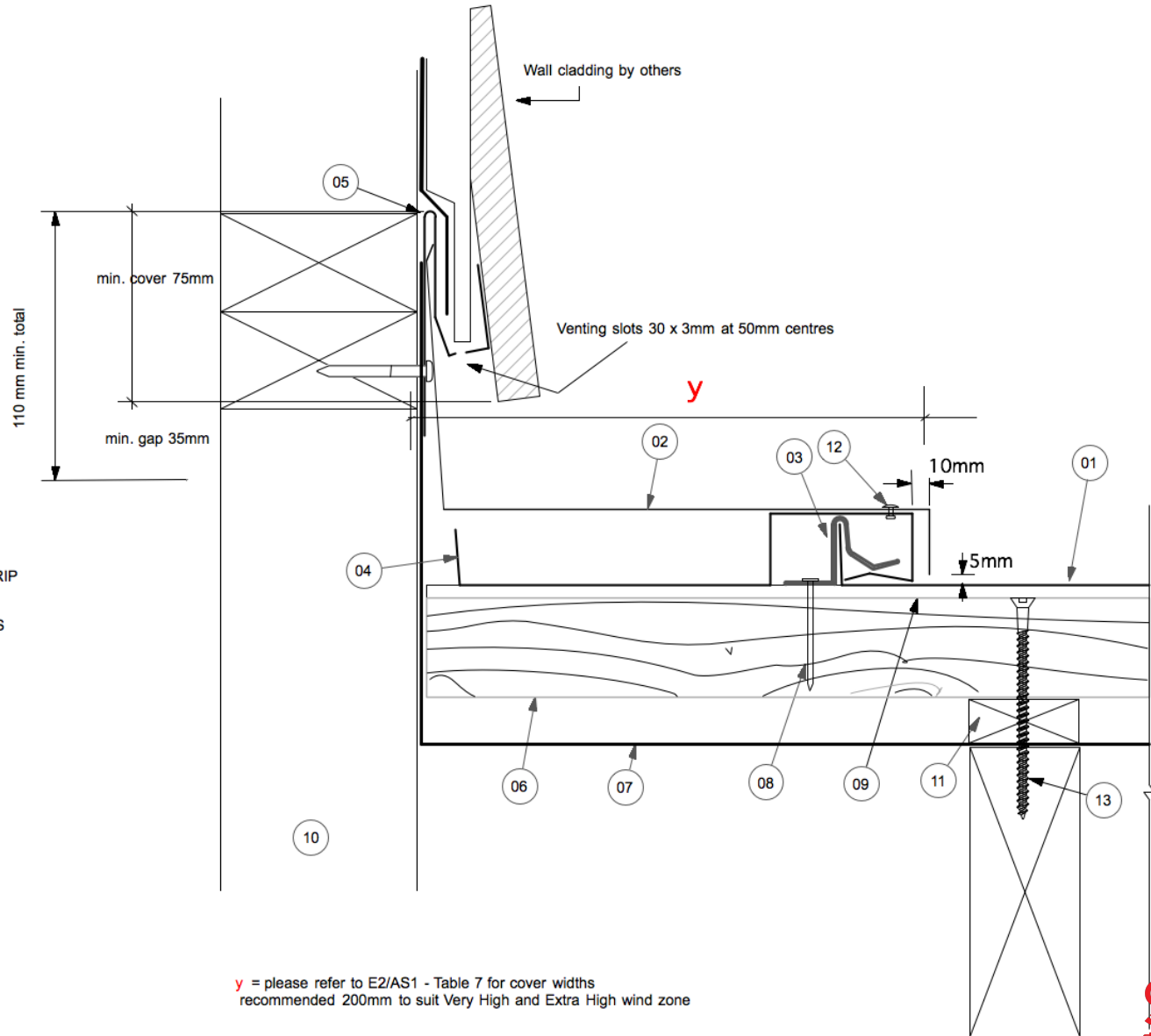

y = please refer to E2/AS1 - Table 7 for cover widths
recommended 200mm to suit Very High and Extra High wind zone



www.qbt450.nz

QUICK BATTEN TRAY SYSTEM - QBT 450™

APRON ROOF/WALL JUNCTION, WITH DIRECT FIXING OPTION

COPYRIGHT RESERVED NO REPRODUCTION OR COPY WITHOUT WRITTEN CONSENT FROM CONSTRUCTION CONNECTION AND CONSULTANCY LTD

Date: 20.05.2020

Scale: 1:2 on A3

REV: 01 A-14